

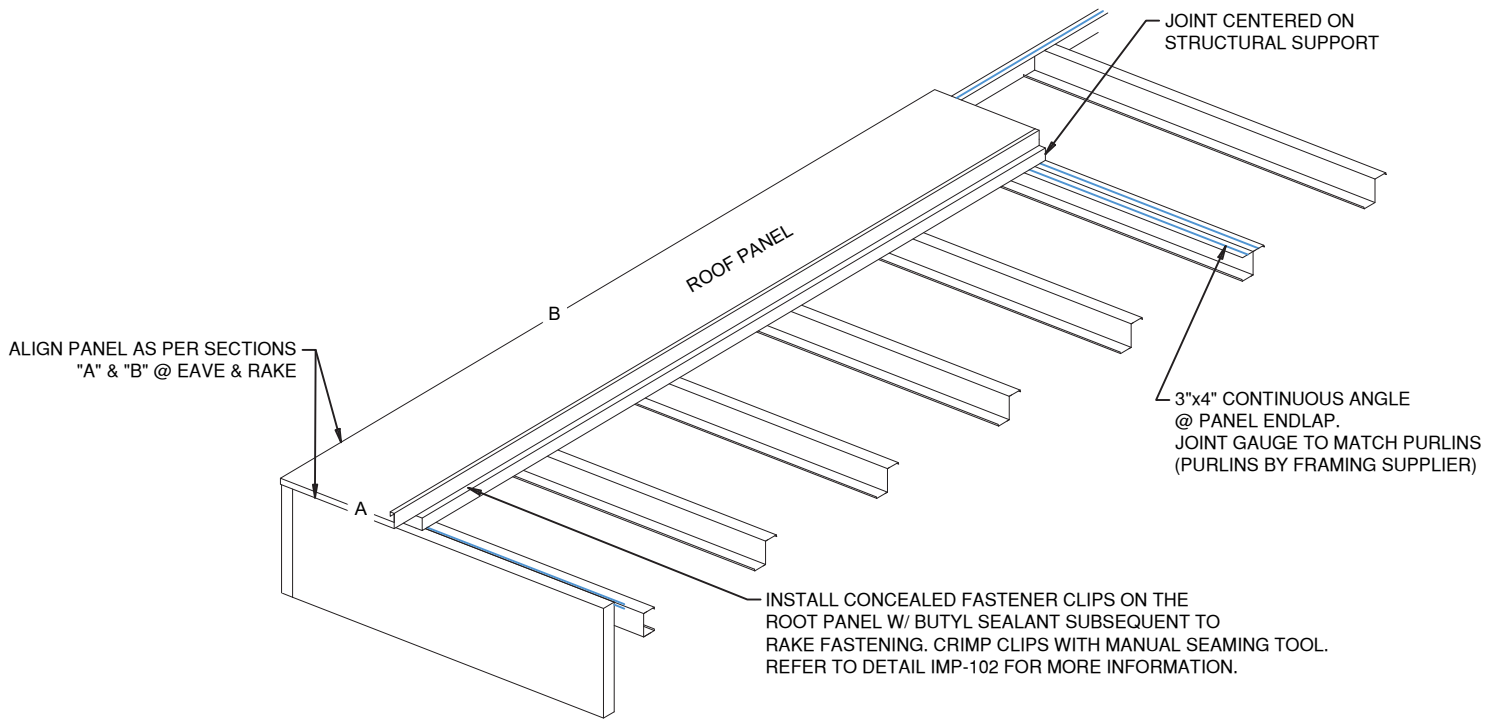

PROFILE <b>IMP ROOF PANELS</b>		APPLICATION <b>COMMERCIAL - INDUSTRIAL</b>	
DETAIL <b>ROOF PANEL INSTALLATION - SEQUENCE 1</b>		SHT. <b>IMP-101</b>	DATE <b>JAN 6/21</b>
			REV. <b>A</b>



**NOTES:**

- FIELD CUT PANEL TO REQUIRED WIDTH.
- USE "C" CLAMPS TO TEMPORARILY HOLD THE CUT EDGE OF THE PANEL TO THE RAKE ANGLE AND FASTEN AS SPECIFIED.

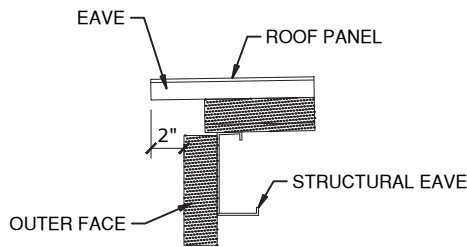

**SECTION A - ROOF PANEL @ OUTER FACE**

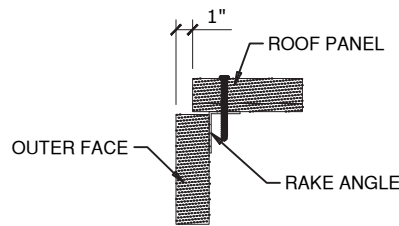

**SECTION B - ROOF PANEL @ OUTER FACE**

- NOTES:**
- A. DETAILS ARE FOR GUIDELINES ONLY, AND MAY NOT BE SUITABLE FOR ALL BUILDING DESIGNS AND CONDITIONS.
  - B. SCREW LENGTHS MAY VARY PER CUSTOMER REQUEST. #12-14x1", #12-14x1 1/2", #12-14x2", #12-14x3" ARE AVAILABLE.

PROFILE	APPLICATION		
<b>IMP ROOF PANELS</b>	<b>COMMERCIAL - INDUSTRIAL</b>		
DETAIL	SHT.	DATE	REV.
<b>ROOF PANEL INSTALLATION - SEQUENCE 2</b>	<b>IMP-101A</b>	<b>JAN 6/21</b>	<b>A</b>

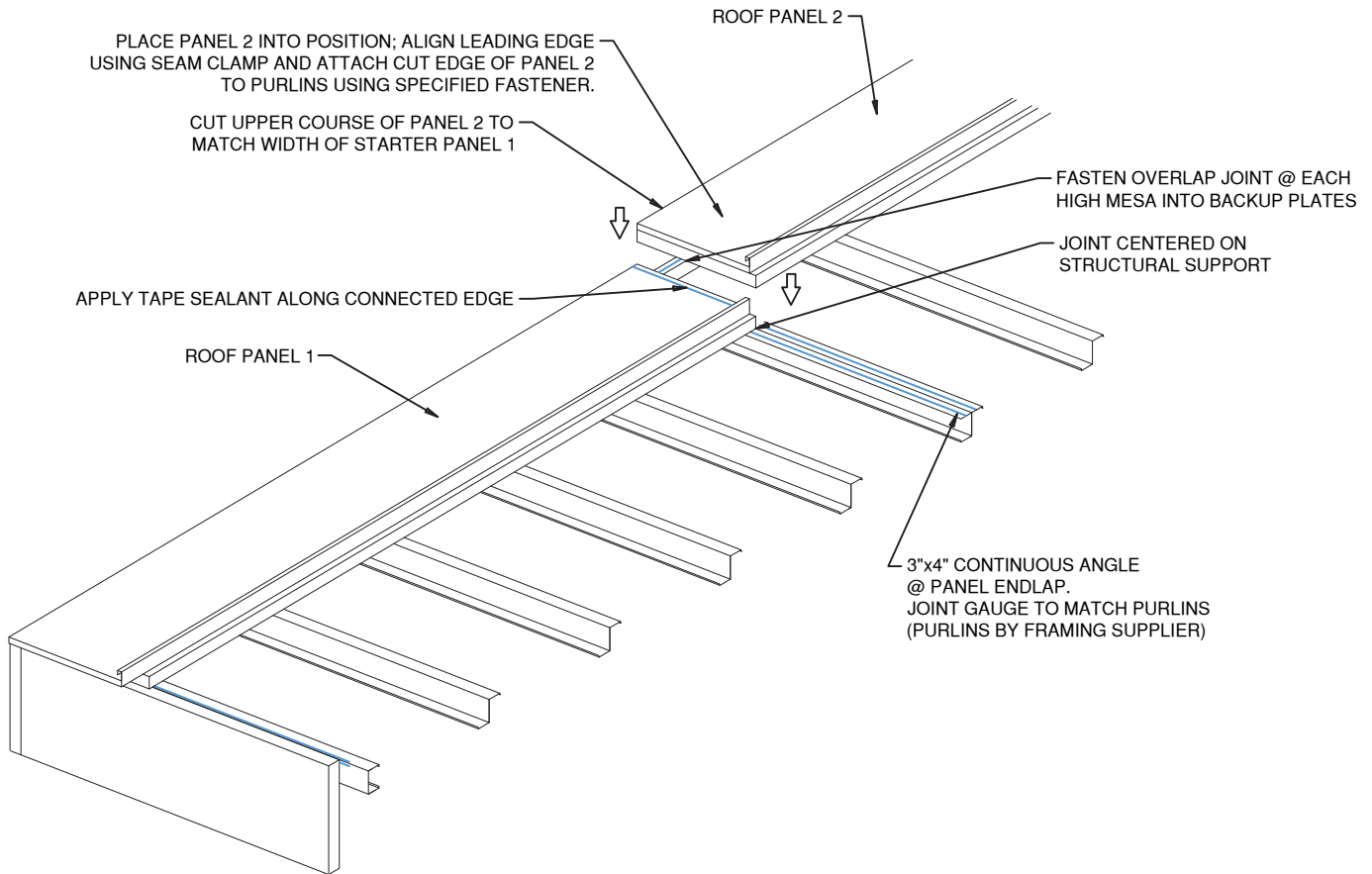

**NOTES:**

- STAND ON ROOF PANEL 2 TO FIRMLY SEAT ENDLAP. INSPECT THE GAP BETWEEN THE ROOF PANELS TO ENSURE A TIGHT FIT.
- INSTALL TWO CLIPS AT PANEL ENDLAP FOLLOWING EDGE FASTENING. CRIMP BOTH CLIPS WITH MANUAL SEAMING TOOL BEFORE INSTALLING NEXT COURSE OF PANELS.
- REFER TO DETAIL IMP-101B FOR MORE INFORMATION

PROFILE	APPLICATION		
<b>IMP ROOF PANELS</b>	<b>COMMERCIAL - INDUSTRIAL</b>		
DETAIL	SHT.	DATE	REV.
<b>ROOF PANEL INSTALLATION - SEQUENCE 3</b>	<b>IMP-101B</b>	<b>JAN 6/21</b>	<b>A</b>

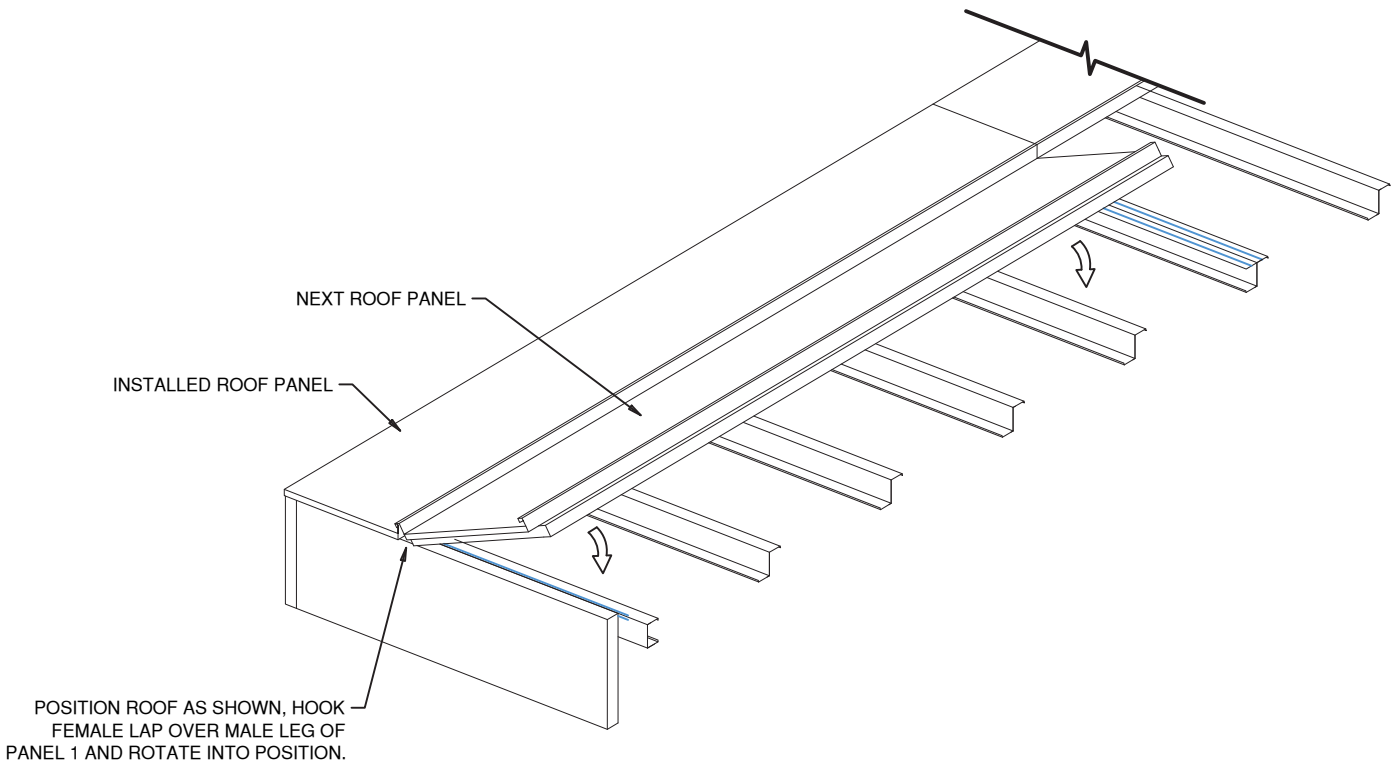

**NOTE:**  
- USE RIB CLAMPS TO PULL PANEL SIDELAPS TOGETHER.

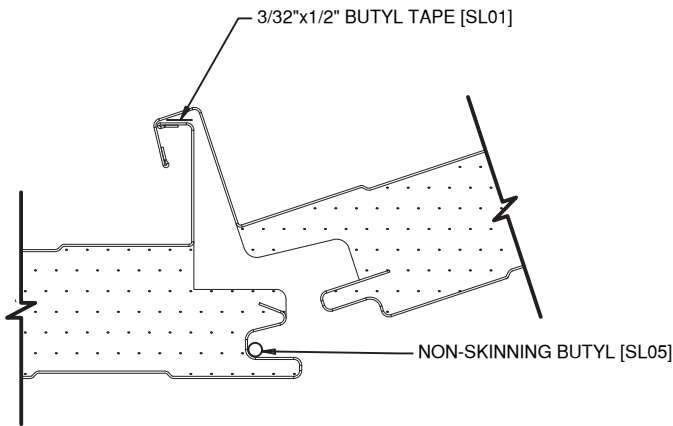

**PANEL ATTACHMENT (1)**

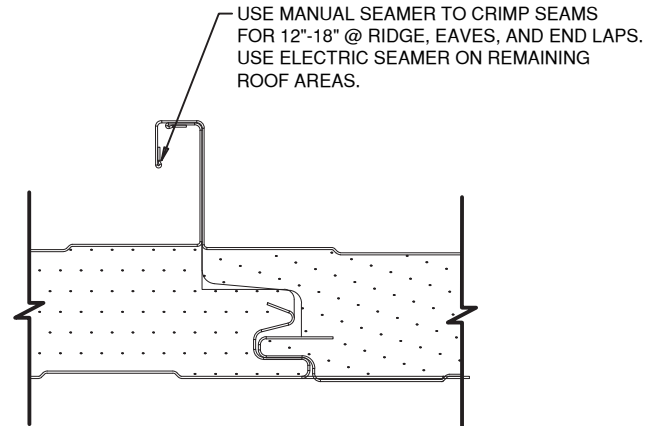

**PANEL ATTACHMENT (2)**

**NOTES:**  
A. DETAILS ARE FOR GUIDELINES ONLY, AND MAY NOT BE SUITABLE FOR ALL BUILDING DESIGNS AND CONDITIONS.  
B. SCREW LENGTHS MAY VARY PER CUSTOMER REQUEST. #12-14x1", #12-14x1 1/2", #12-14x2", #12-14x3" ARE AVAILABLE.

PROFILE	APPLICATION		
<b>IMP ROOF PANELS</b>	<b>COMMERCIAL - INDUSTRIAL</b>		
DETAIL	SHT.	DATE	REV.
<b>ROOF PANEL SIDELAP</b>	<b>IMP-102</b>	<b>JAN 6/21</b>	<b>A</b>

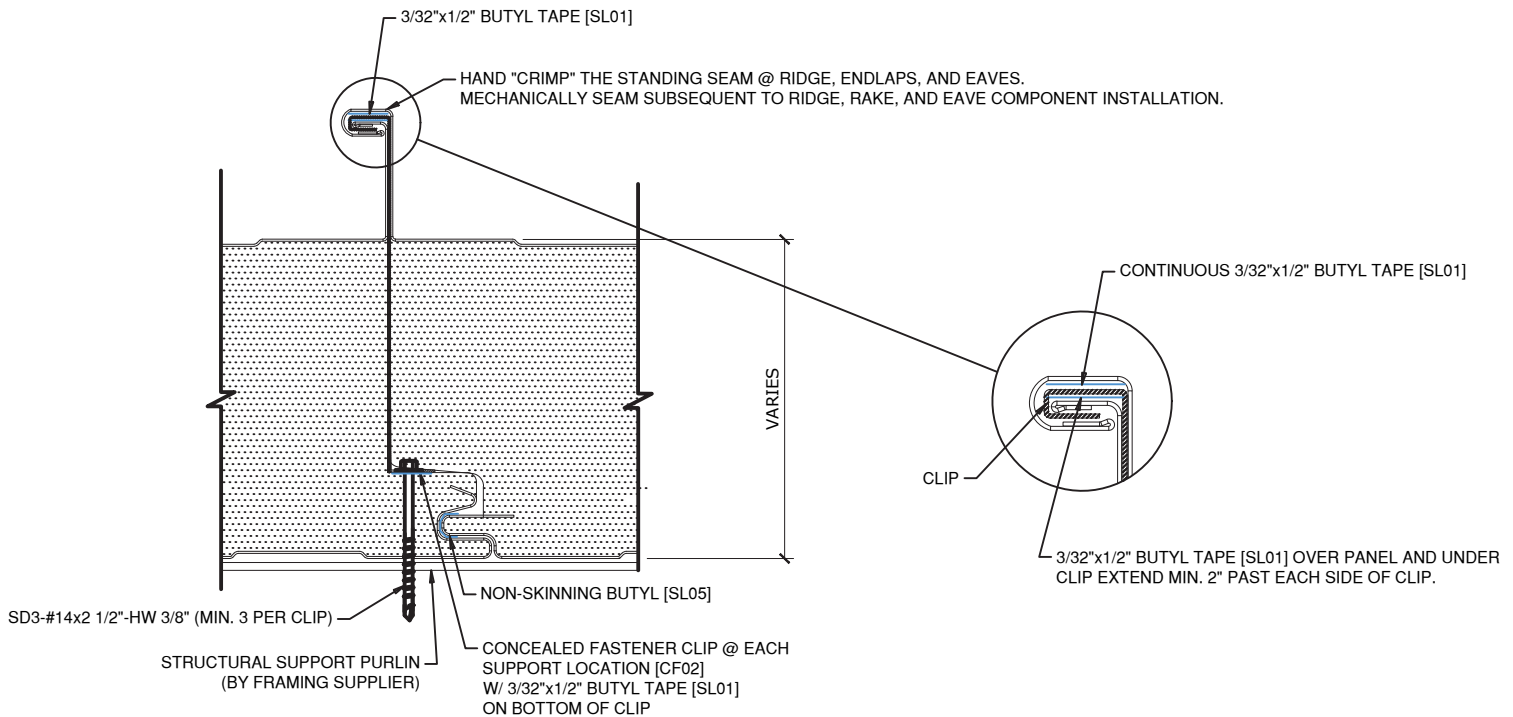
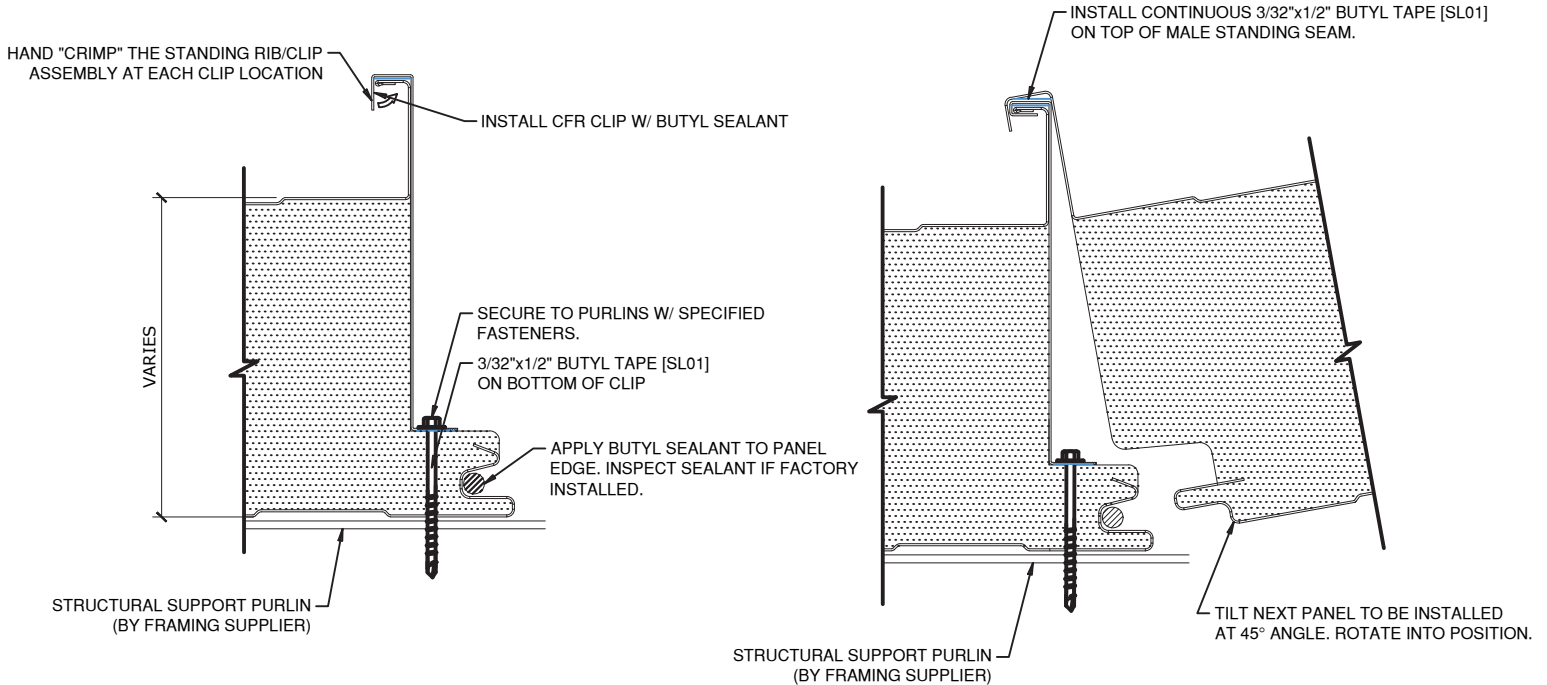

**NOTE:**  
- USE CLAMPS TO ENSURE PROPER PANEL ALIGNMENT.

**NOTES:**  
A. DETAILS ARE FOR GUIDELINES ONLY, AND MAY NOT BE SUITABLE FOR ALL BUILDING DESIGNS AND CONDITIONS.  
B. SCREW LENGTHS MAY VARY PER CUSTOMER REQUEST. #12-14x1", #12-14x1 1/2", #12-14x2", #12-14x3" ARE AVAILABLE.

PROFILE	APPLICATION		
IMP ROOF PANELS	COMMERCIAL - INDUSTRIAL		
DETAIL	SHT.	DATE	REV.
ROOF PANEL CLIP CONNECTION	IMP-102A	JAN 6/21	A

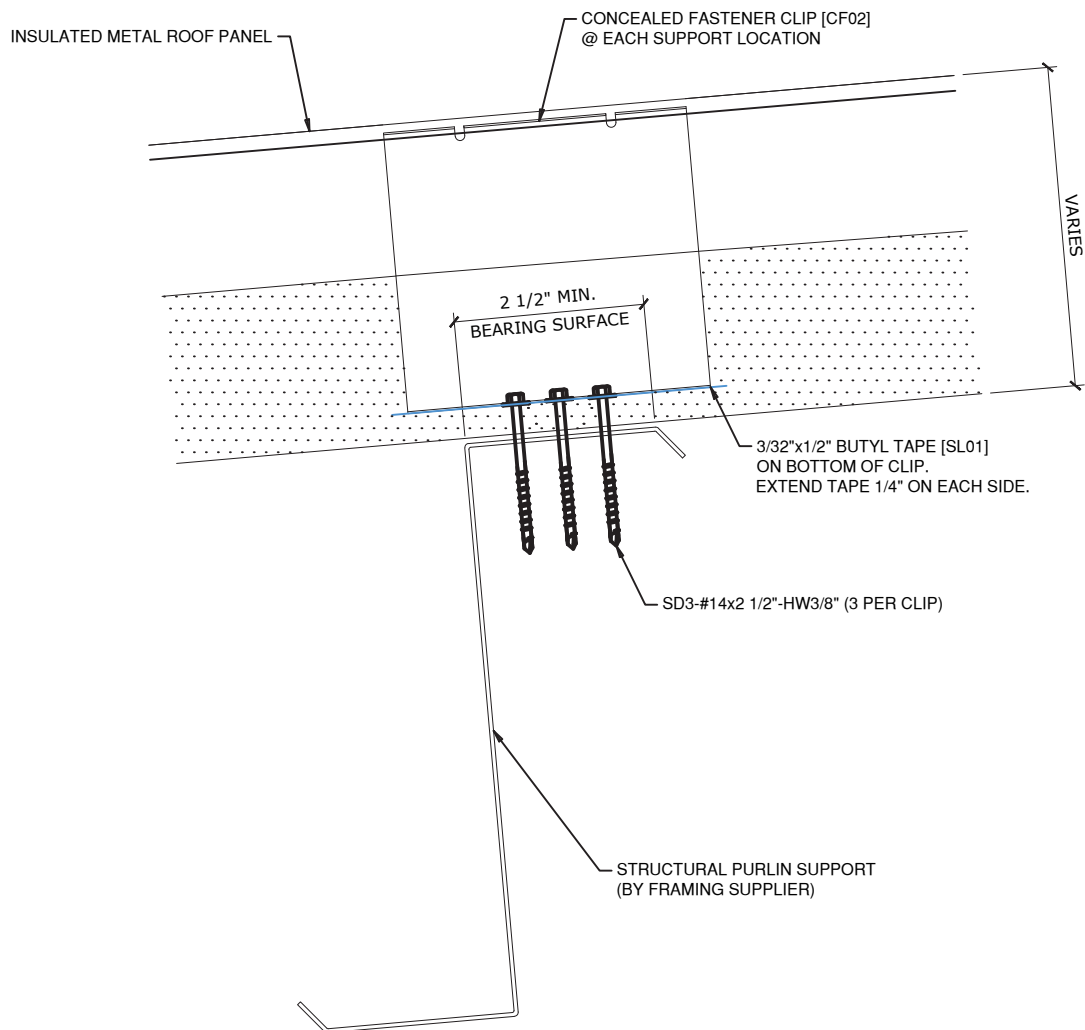

- NOTES:
- A. DETAILS ARE FOR GUIDELINES ONLY, AND MAY NOT BE SUITABLE FOR ALL BUILDING DESIGNS AND CONDITIONS.
  - B. SCREW LENGTHS MAY VARY PER CUSTOMER REQUEST. #12-14x1", #12-14x1 1/2", #12-14x2", #12-14x3" ARE AVAILABLE.

PROFILE	APPLICATION		
IMP ROOF PANELS	COMMERCIAL - INDUSTRIAL		
DETAIL	SHT.	DATE	REV.
ROOF PANEL ENDLAP	IMP-103	JAN 6/21	A

**MINIMUM ROOF SLOPES:**

1/4" in 12" CONTINUOUS ROOF  
 1" in 12" ROOF WITH ENDLAP

1/2" in 12" ROOF WITH ENDLAP - CONSULT MANUFACTURER

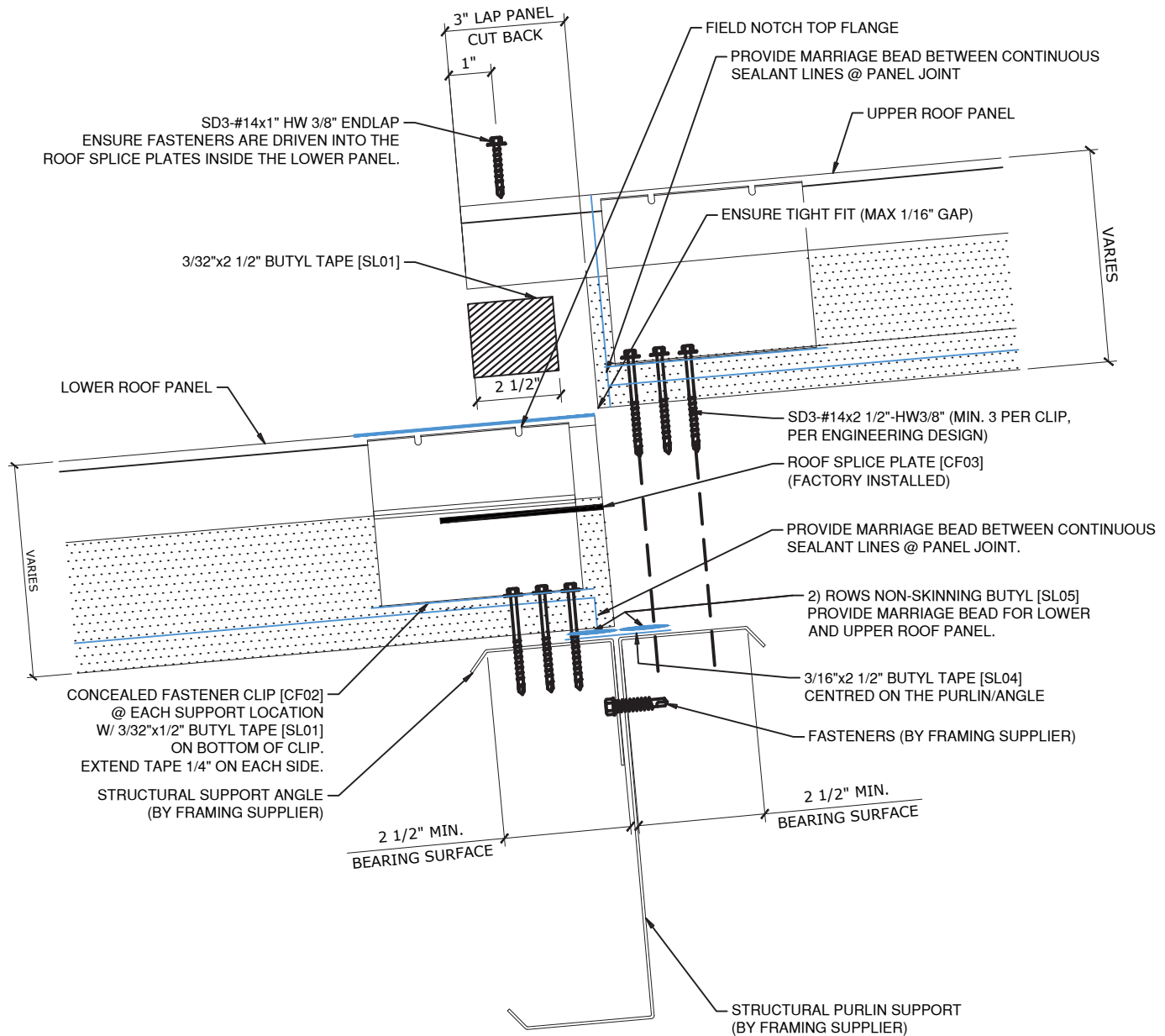

**NOTE:**

- FIELD REMOVE LINER AND INSULATION AT CUTBACK PANEL.
- END LAP STEEL LOCATION IS CRITICAL TO ROOF PANEL LENGTH.

NOTES:  
 A. DETAILS ARE FOR GUIDELINES ONLY, AND MAY NOT BE SUITABLE FOR ALL BUILDING DESIGNS AND CONDITIONS.  
 B. SCREW LENGTHS MAY VARY PER CUSTOMER REQUEST. #12-14x1", #12-14x1 1/2", #12-14x2", #12-14x3" ARE AVAILABLE.

PROFILE	APPLICATION		
IMP ROOF PANELS	COMMERCIAL - INDUSTRIAL		
DETAIL	SHT.	DATE	REV.
HIGH EAVE	IMP-104	JAN 6/21	A

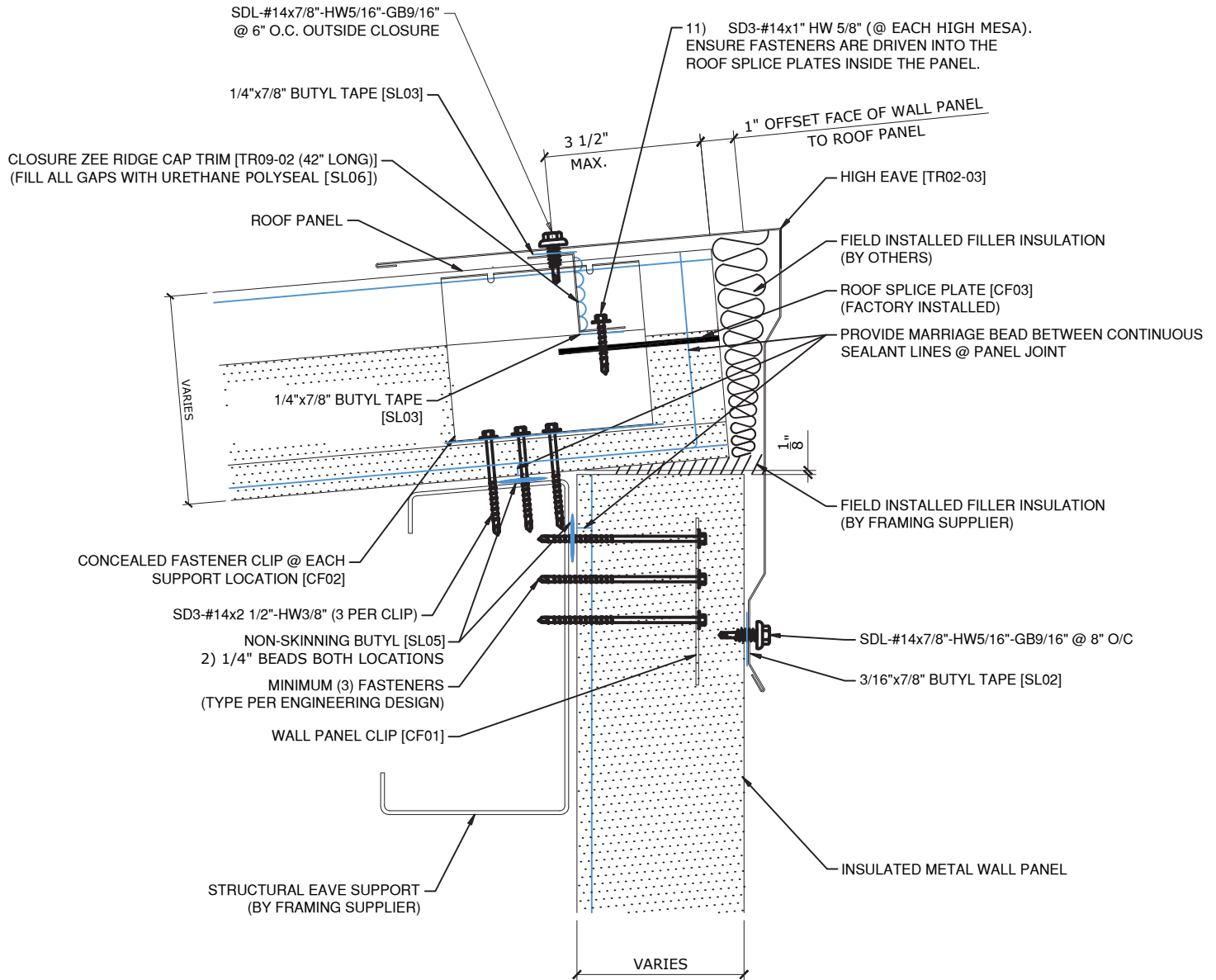

**NOTE:**

- TRANSITION FLASHING IS INSTALLED WITH A PITCH 1/2:12 GREATER THAN THE ROOF PITCH.
- FILLER INSULATION MATERIAL AND APPLICATION IS SPECIFIED BY THE PROJECT DESIGNER.
- TOP OF WALL PANEL TO BE PROTECTED FROM WEATHER DURING CONSTRUCTION.

- NOTES:
- A. DETAILS ARE FOR GUIDELINES ONLY, AND MAY NOT BE SUITABLE FOR ALL BUILDING DESIGNS AND CONDITIONS.
  - B. SCREW LENGTHS MAY VARY PER CUSTOMER REQUEST. #12-14x1", #12-14x1 1/2", #12-14x2", #12-14x3" ARE AVAILABLE.



PROFILE	APPLICATION		
IMP ROOF PANELS	COMMERCIAL - INDUSTRIAL		
DETAIL	SHT.	DATE	REV.
LOW EAVE WITH GUTTER	IMP-105	JAN 6/21	A

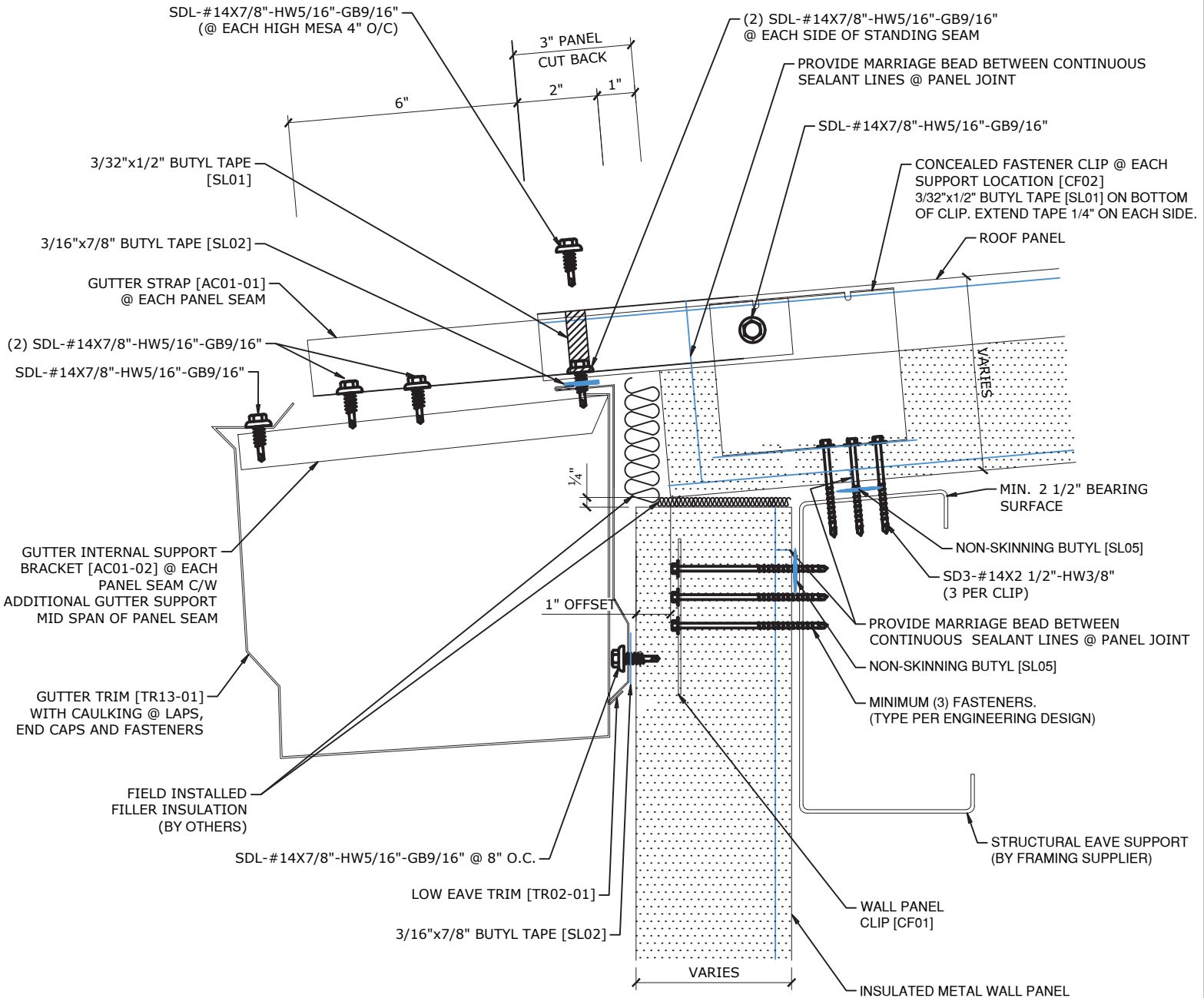

**NOTE:**

- FIELD REMOVE LINER AND INSULATION AT CUTBACK PANEL.
- FILLER INSULATION MATERIAL AND APPLICATION IS SPECIFIED BY THE PROJECT DESIGNER.
- TOP OF WALL PANEL TO BE PROTECTED FROM WEATHER DURING CONSTRUCTION.

**NOTES:**

- A. DETAILS ARE FOR GUIDELINES ONLY, AND MAY NOT BE SUITABLE FOR ALL BUILDING DESIGNS AND CONDITIONS.
- B. SCREW LENGTHS MAY VARY PER CUSTOMER REQUEST. #12-14x1", #12-14x1 1/2", #12-14x2", #12-14x3" ARE AVAILABLE.

PROFILE	APPLICATION		
<b>IMP ROOF PANELS</b>	<b>COMMERCIAL - INDUSTRIAL</b>		
DETAIL	SHT.	DATE	REV.
<b>LOW EAVE WITH TRIM</b>	<b>IMP-105A</b>	<b>JAN 6/21</b>	<b>A</b>

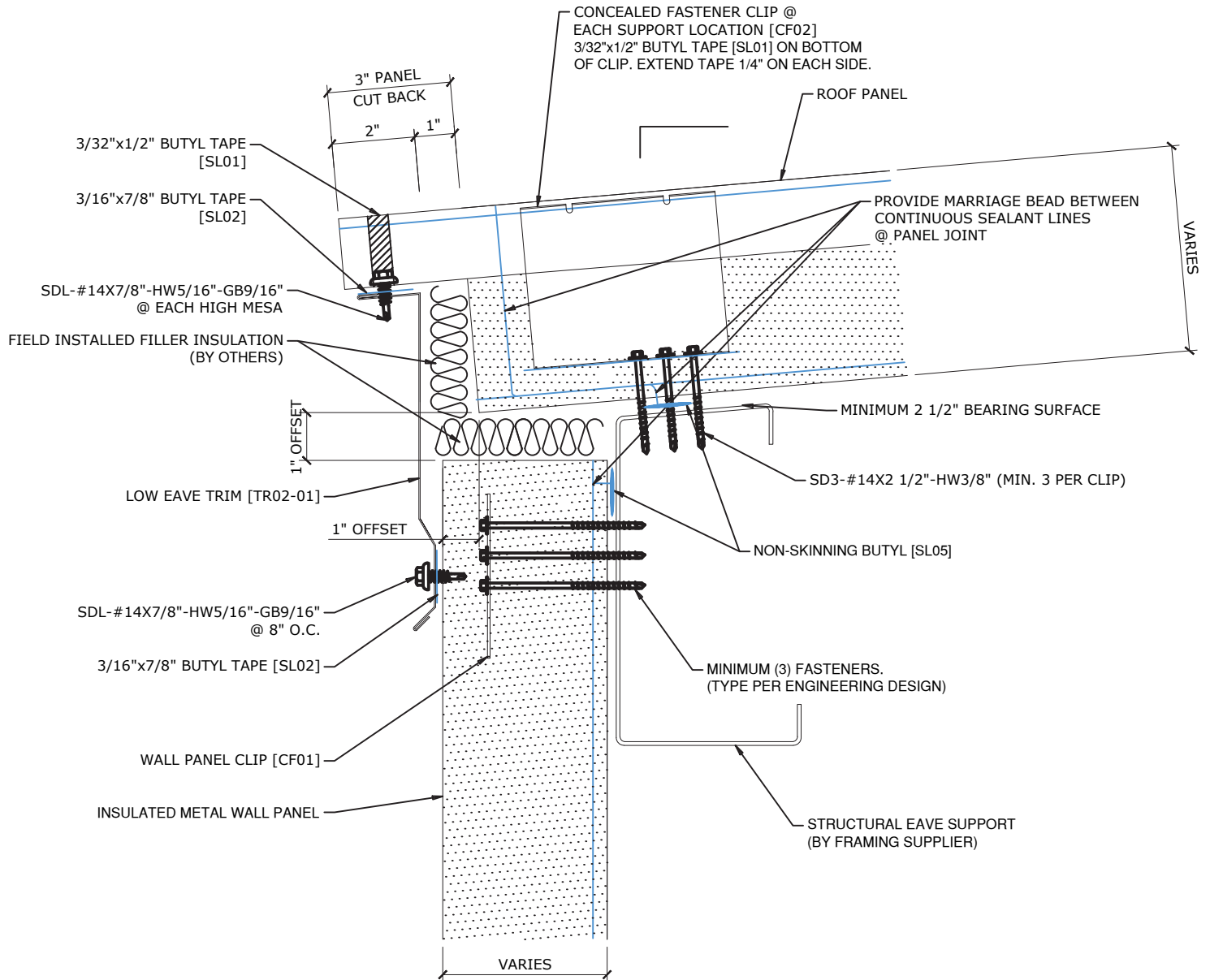

**NOTE:**  
 - FIELD REMOVE LINER AND INSULATION AT CUTBACK PANEL.  
 - FILLER INSULATION MATERIAL AND APPLICATION IS SPECIFIED BY THE PROJECT DESIGNER.  
 - TOP OF WALL PANEL TO BE PROTECTED FROM WEATHER DURING CONSTRUCTION.

**NOTES:**  
 A. DETAILS ARE FOR GUIDELINES ONLY, AND MAY NOT BE SUITABLE FOR ALL BUILDING DESIGNS AND CONDITIONS.  
 B. SCREW LENGTHS MAY VARY PER CUSTOMER REQUEST. #12-14x1", #12-14x1 1/2", #12-14x2", #12-14x3" ARE AVAILABLE.

PROFILE	APPLICATION		
<b>IMP ROOF PANELS</b>	<b>COMMERCIAL - INDUSTRIAL</b>		
DETAIL	SHT.	DATE	REV.
<b>RAKE AT WALL PANEL</b>	<b>IMP-106</b>	<b>JAN 6/21</b>	<b>A</b>

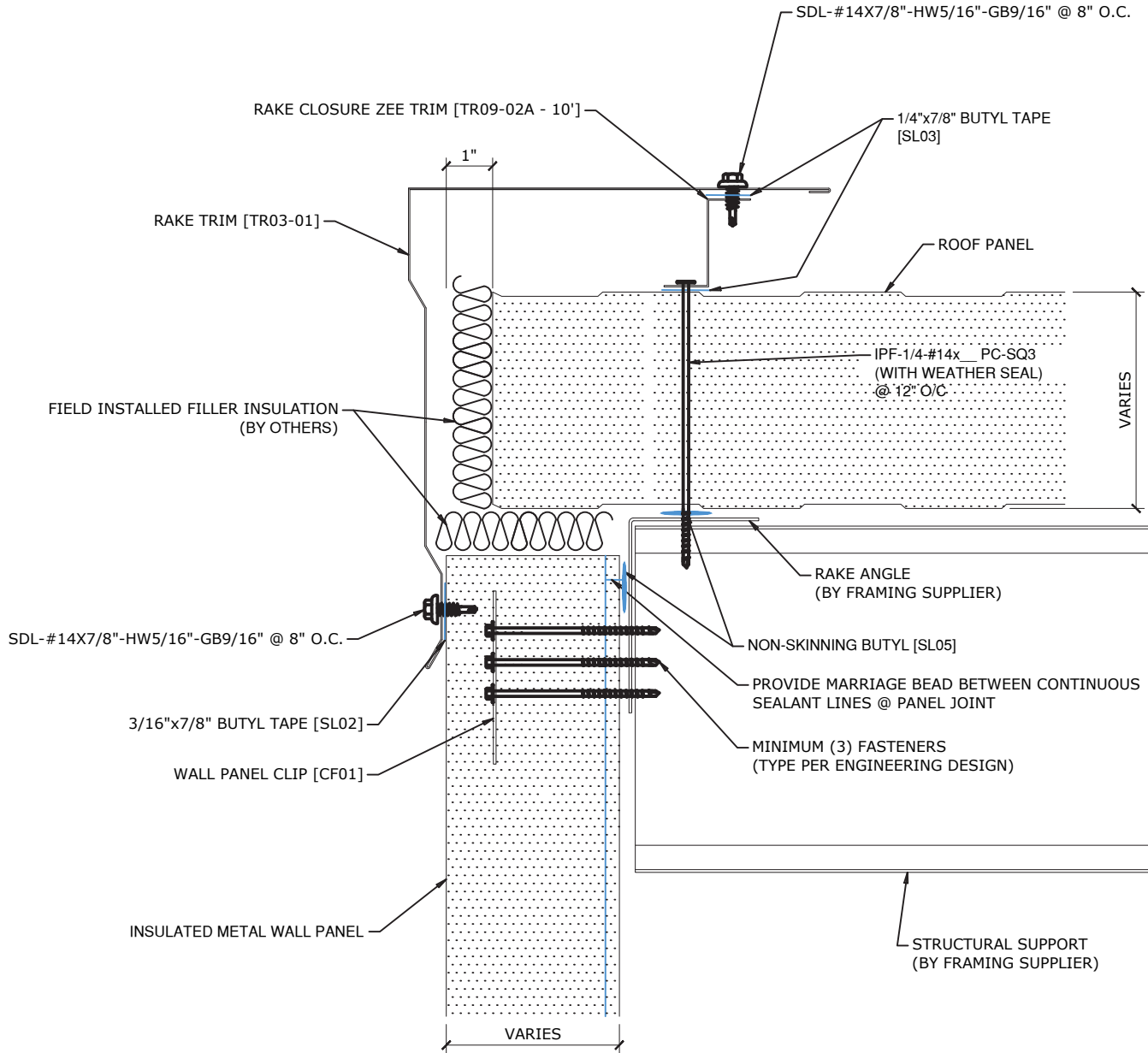

**NOTE:**

- FILLER INSULATION MATERIAL AND APPLICATION IS SPECIFIED BY THE PROJECT DESIGNER.
- TOP OF WALL PANEL TO BE PROTECTED FROM WEATHER DURING CONSTRUCTION.

- NOTES:**
- A. DETAILS ARE FOR GUIDELINES ONLY, AND MAY NOT BE SUITABLE FOR ALL BUILDING DESIGNS AND CONDITIONS.
  - B. SCREW LENGTHS MAY VARY PER CUSTOMER REQUEST. #12-14x1", #12-14x1 1/2", #12-14x2", #12-14x3" ARE AVAILABLE.

PROFILE	APPLICATION		
IMP ROOF PANELS	COMMERCIAL - INDUSTRIAL		
DETAIL	SHT.	DATE	REV.
STACK JOINT TO HIGH EAVE	IMP-107	JAN 6/21	A

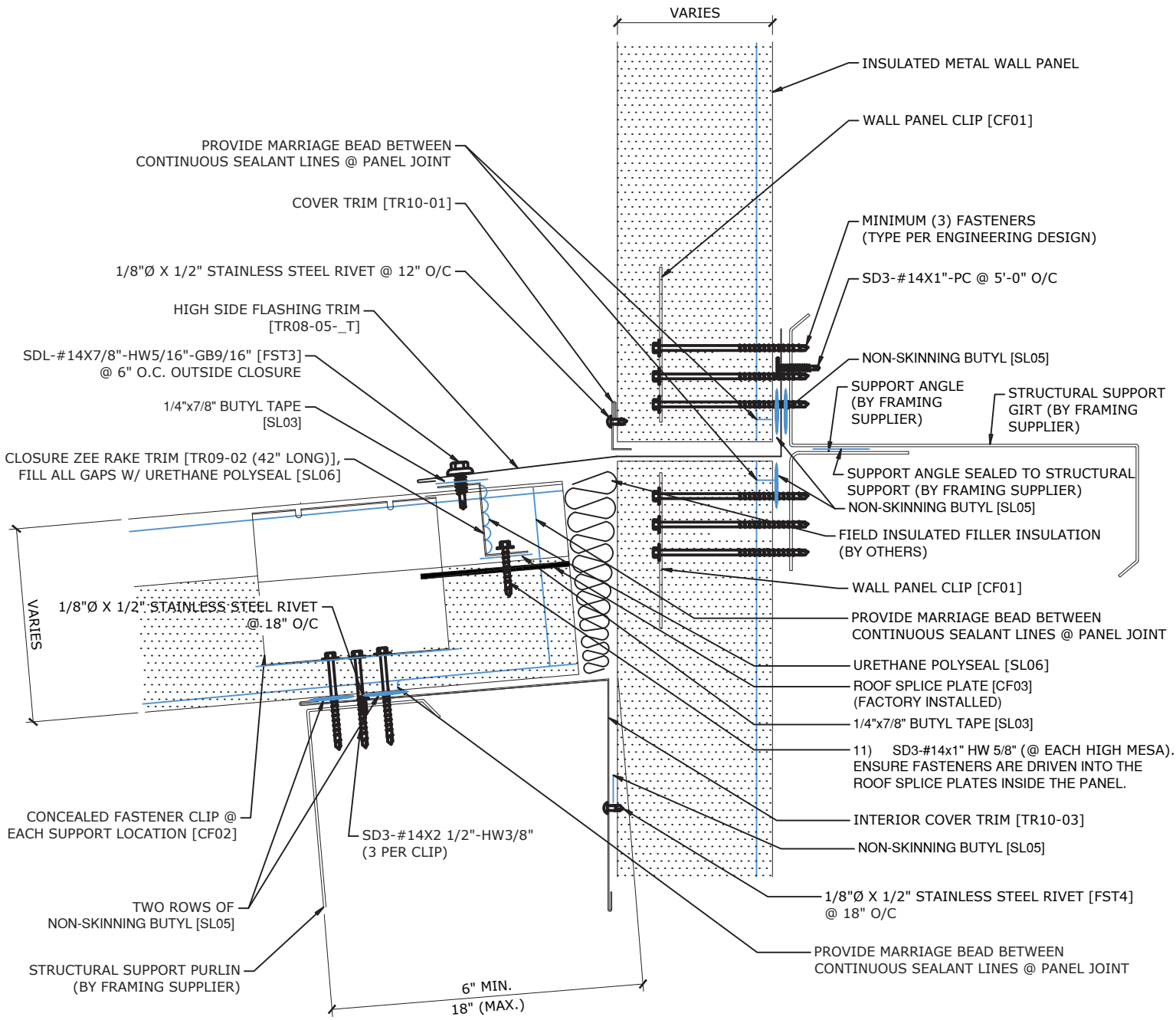

**NOTE:**  
 - TRANSITION FLASHING IS INSTALLED WITH A PITCH 1/2:12 GREATER THAN THE ROOF PITCH  
 - FILLER INSULATION MATERIAL AND APPLICATION IS SPECIFIED BY THE PROJECT DESIGNER.  
 - TOP OF WALL PANEL TO BE PROTECTED FROM WEATHER DURING CONSTRUCTION.

**NOTES:**  
 A. DETAILS ARE FOR GUIDELINES ONLY, AND MAY NOT BE SUITABLE FOR ALL BUILDING DESIGNS AND CONDITIONS.  
 B. SCREW LENGTHS MAY VARY PER CUSTOMER REQUEST. #12-14x1", #12-14x1 1/2", #12-14x2", #12-14x3" ARE AVAILABLE.

PROFILE	APPLICATION		
IMP ROOF PANELS	COMMERCIAL - INDUSTRIAL		
DETAIL	SHT.	DATE	REV.
WALL TO HIGH EAVE	IMP-107A	JAN 6/21	A

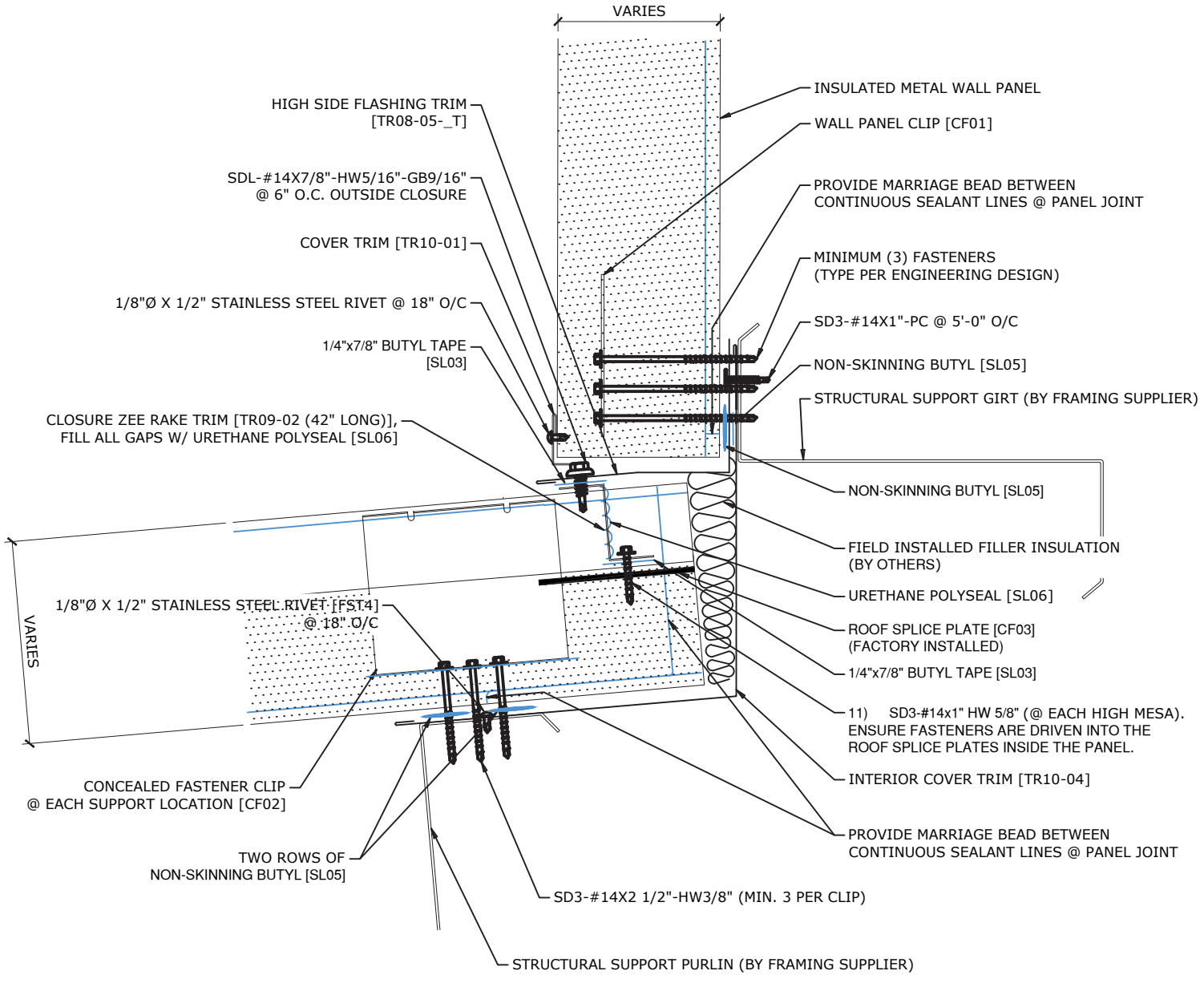

**NOTE:**  
 - TRANSITION FLASHING IS INSTALLED WITH A PITCH 1/2:12 GREATER THAN THE ROOF PITCH  
 - FILLER INSULATION MATERIAL AND APPLICATION IS SPECIFIED BY THE PROJECT DESIGNER.

**NOTES:**  
 A. DETAILS ARE FOR GUIDELINES ONLY, AND MAY NOT BE SUITABLE FOR ALL BUILDING DESIGNS AND CONDITIONS.  
 B. SCREW LENGTHS MAY VARY PER CUSTOMER REQUEST. #12-14x1", #12-14x1 1/2", #12-14x2", #12-14x3" ARE AVAILABLE.

PROFILE	APPLICATION		
<b>IMP ROOF PANELS</b>	<b>COMMERCIAL - INDUSTRIAL</b>		
DETAIL	SHT.	DATE	REV.
<b>WALL TO ROOF RAKE</b>	<b>IMP-108</b>	<b>JAN 6/21</b>	<b>A</b>

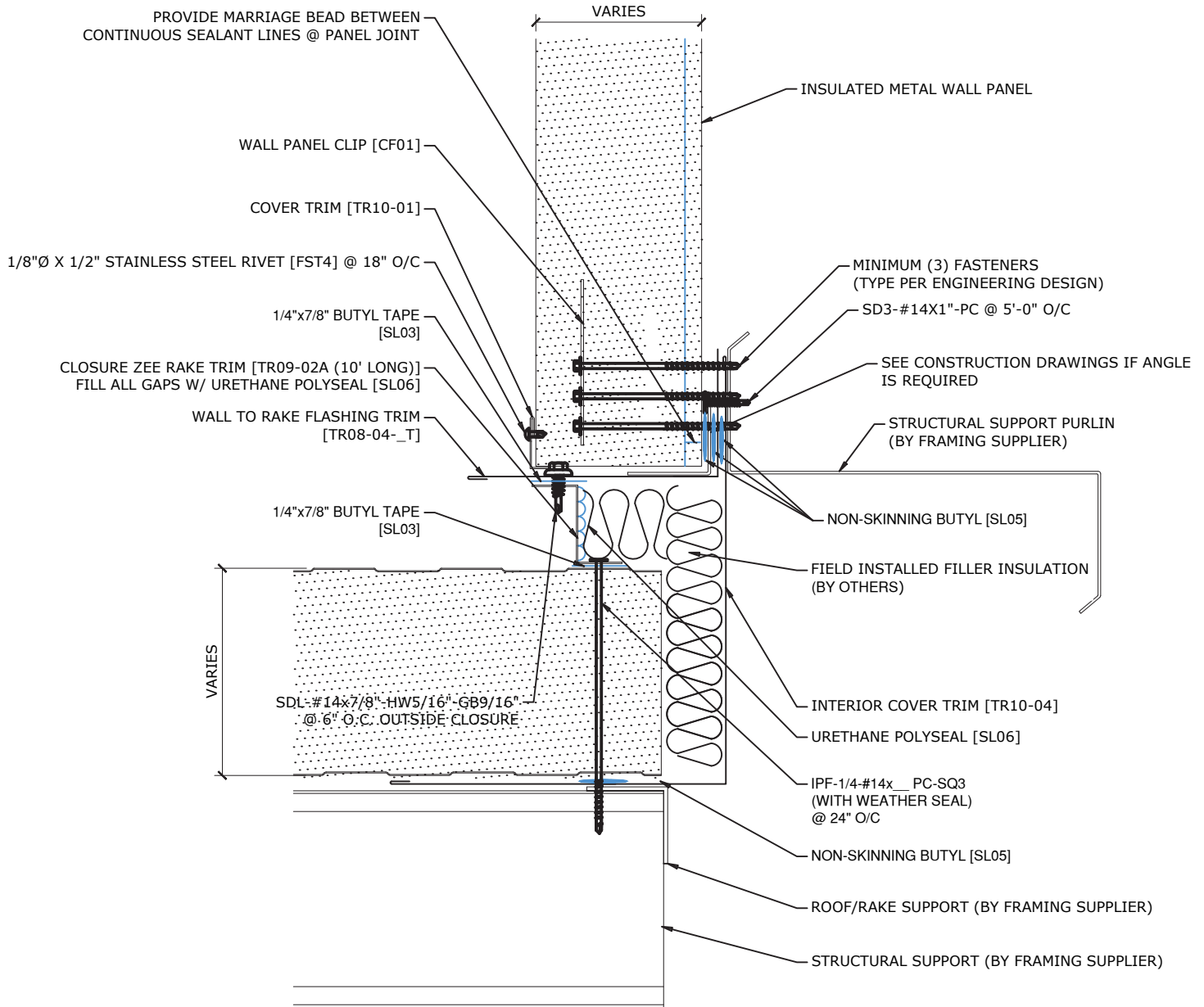

**NOTE:**

- TRANSITION FLASHING IS INSTALLED WITH A PITCH 1/2:12 GREATER THAN THE ROOF PITCH
- FILLER INSULATION MATERIAL AND APPLICATION IS SPECIFIED BY THE PROJECT DESIGNER.

NOTES:  
 A. DETAILS ARE FOR GUIDELINES ONLY, AND MAY NOT BE SUITABLE FOR ALL BUILDING DESIGNS AND CONDITIONS.  
 B. SCREW LENGTHS MAY VARY PER CUSTOMER REQUEST. #12-14x1", #12-14x1 1/2", #12-14x2", #12-14x3" ARE AVAILABLE.

PROFILE	APPLICATION		
IMP ROOF PANELS	COMMERCIAL - INDUSTRIAL		
DETAIL	SHT.	DATE	REV.
RIDGE DETAIL	IMP-109	JAN 6/21	A

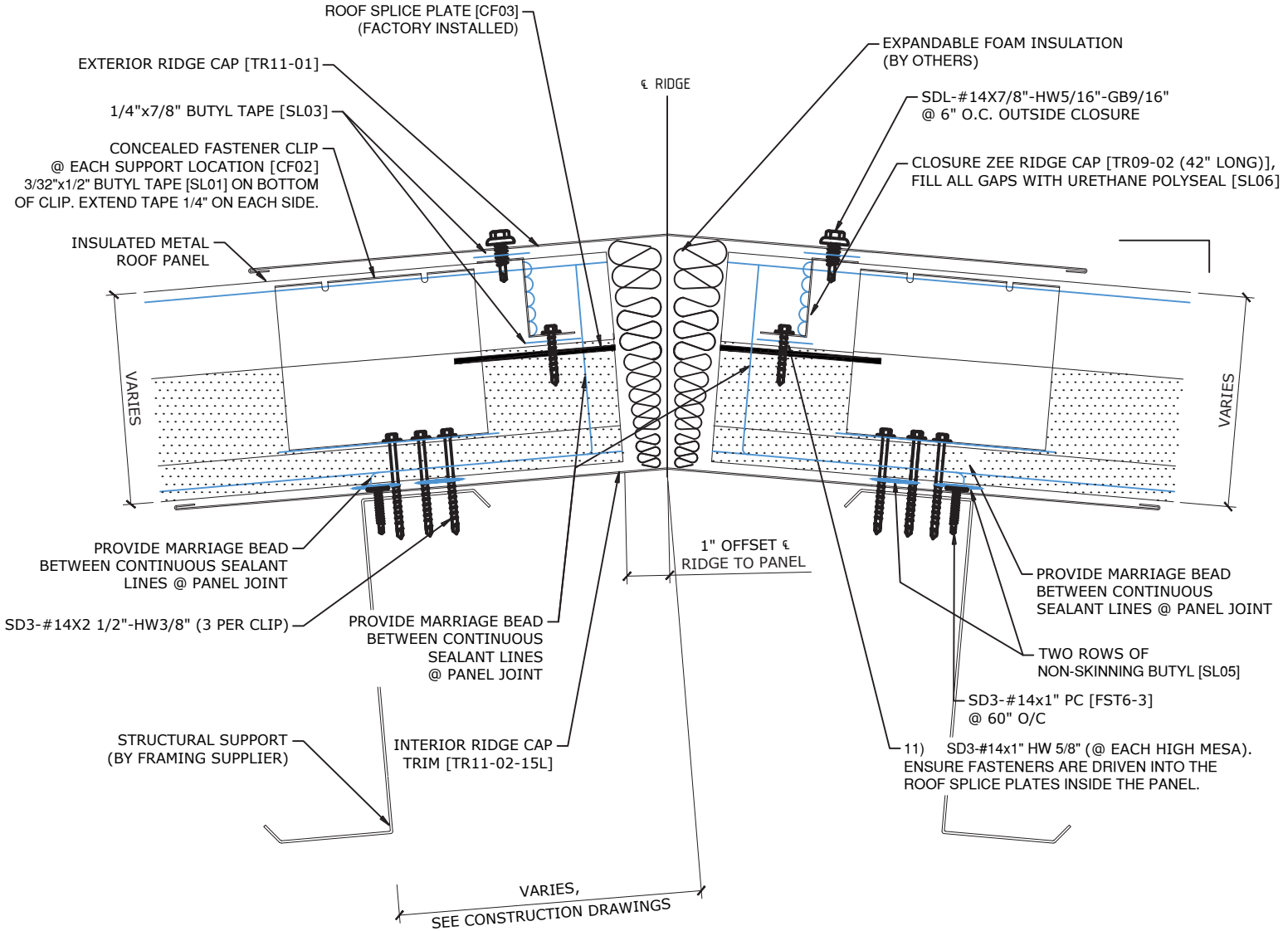

**NOTE:**  
 - FILLER INSULATION MATERIAL AND APPLICATION IS SPECIFIED BY THE PROJECT DESIGNER.  
 - REDUCE PANEL EXTENSION IN SNOW DRIFT CONDITIONS.

**NOTES:**  
 A. DETAILS ARE FOR GUIDELINES ONLY, AND MAY NOT BE SUITABLE FOR ALL BUILDING DESIGNS AND CONDITIONS.  
 B. SCREW LENGTHS MAY VARY PER CUSTOMER REQUEST. #12-14x1", #12-14x1 1/2", #12-14x2", #12-14x3" ARE AVAILABLE.



PROFILE	APPLICATION		
<b>IMP ROOF PANELS</b>	<b>COMMERCIAL - INDUSTRIAL</b>		
DETAIL	SHT.	DATE	REV.
<b>HIP DETAIL</b>	<b>IMP-109A</b>	<b>JAN 6/21</b>	<b>A</b>

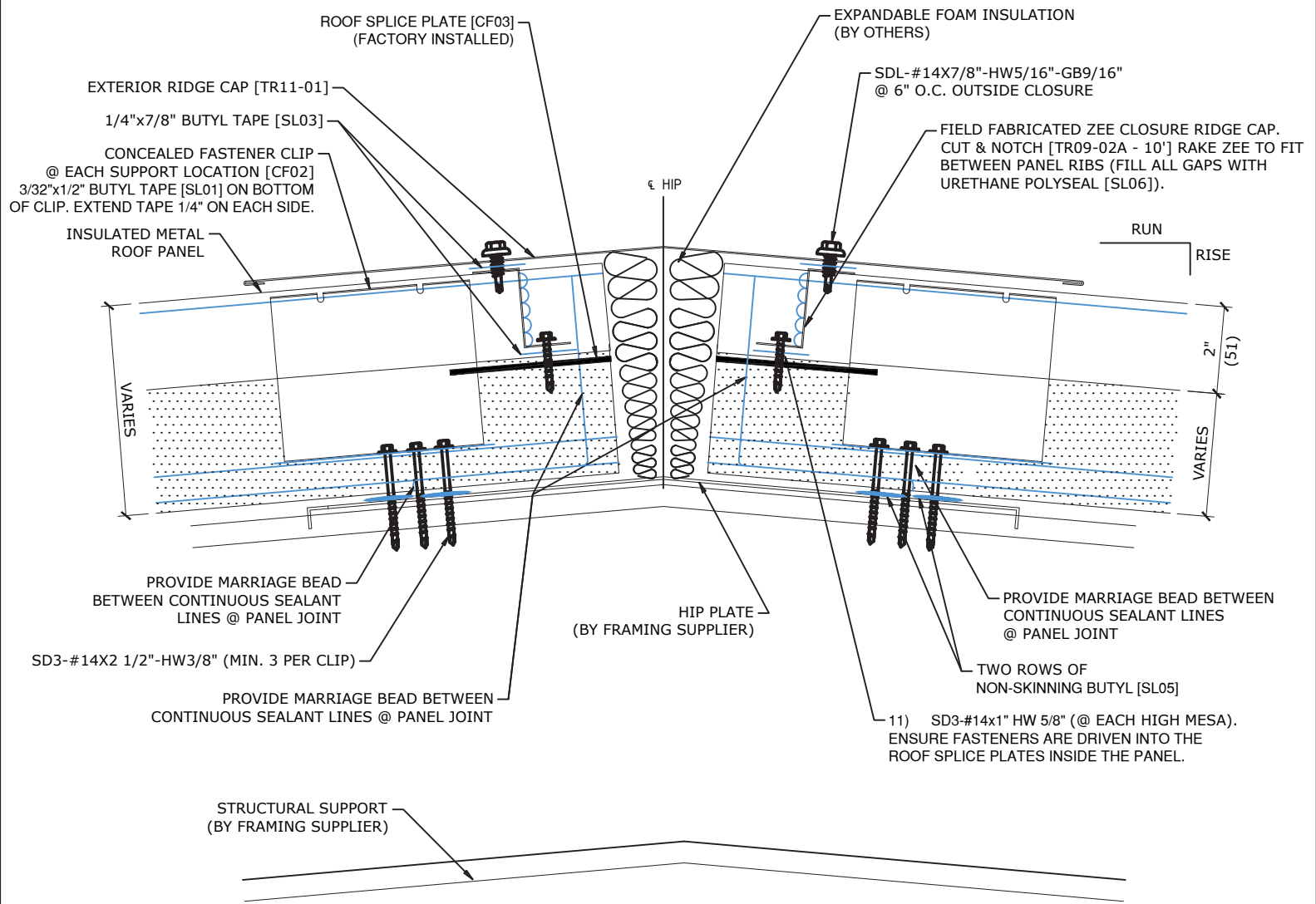

**NOTE:**  
- FILLER INSULATION MATERIAL AND APPLICATION IS SPECIFIED BY THE PROJECT DESIGNER.

**NOTES:**  
A. DETAILS ARE FOR GUIDELINES ONLY, AND MAY NOT BE SUITABLE FOR ALL BUILDING DESIGNS AND CONDITIONS.  
B. SCREW LENGTHS MAY VARY PER CUSTOMER REQUEST. #12-14x1", #12-14x1 1/2", #12-14x2", #12-14x3" ARE AVAILABLE.



PROFILE	APPLICATION		
IMP ROOF PANELS	COMMERCIAL - INDUSTRIAL		
DETAIL	SHT.	DATE	REV.
VALLEY DETAIL	IMP-110	JAN 6/21	A

MINIMUM ROOF SLOPE FOR VALLEYS:  
3" in 12"

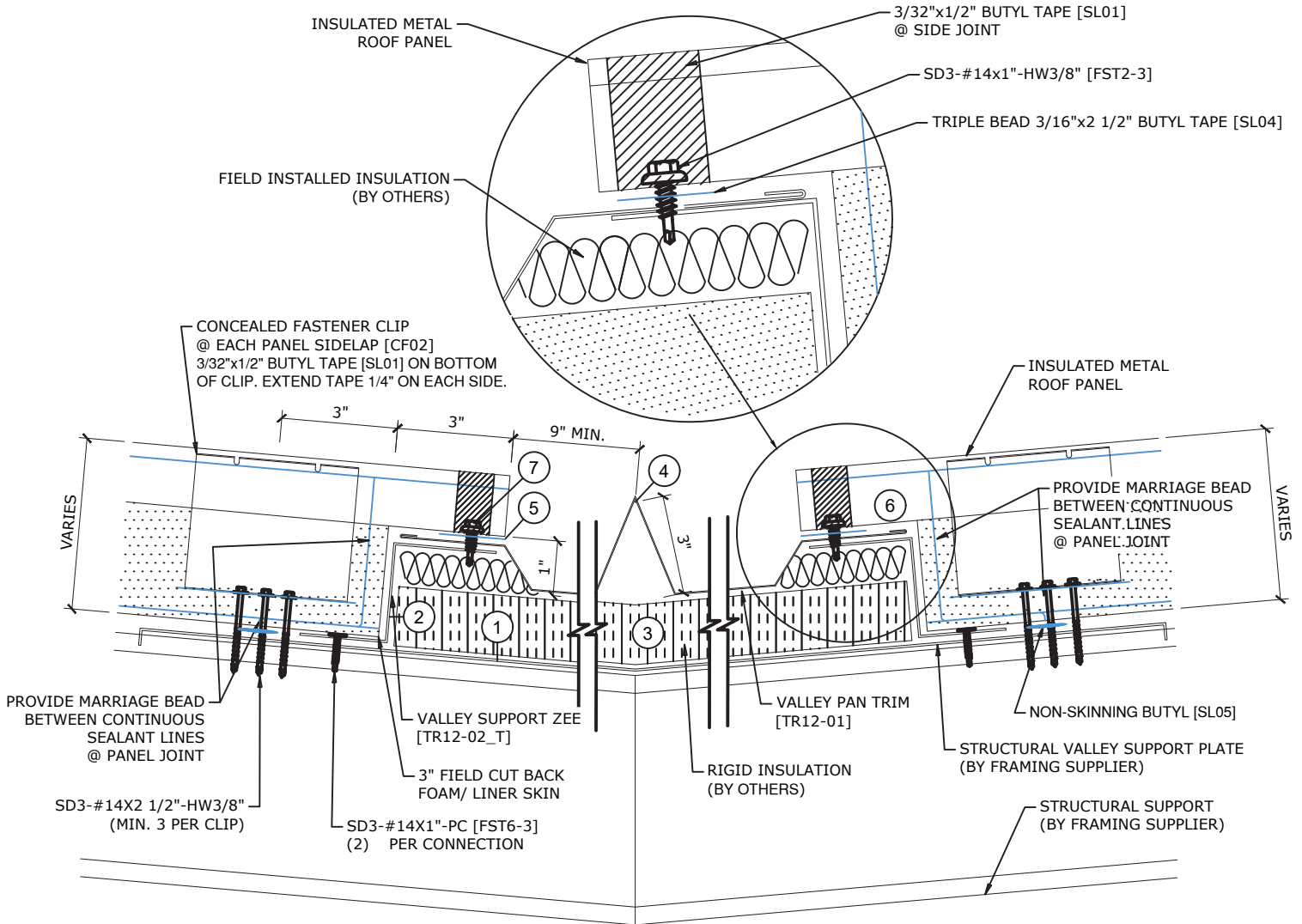

**NOTE:**

- VALLEY DETAIL DOES NOT APPLY FOR DORMER CONDITIONS.
- VALLEY CONDITIONS ARE NOT RECOMMENDED FOR APPLICATIONS WITH ROOF PITCH LESS THAN 3:12.
- THE VALLEY PAN WIDTH VARIES WITH THE ROOF'S DRAINAGE REQUIREMENTS.
- FILLER INSULATION MATERIAL AND APPLICATION IS SPECIFIED BY THE PROJECT DESIGNER.
- RECOMMENDED VALLEY PAN IS 16 GA. MIN. STEEL, WELDED WATER-TIGHT AND COATED OR LINED WITH MEMBRANE.

**INSTALLATION SEQUENCE:**

1. INSTALL STRUCTURAL VALLEY SUPPORT PLATE.
2. FASTEN VALLEY SUPPORT ZEE E/S TO VALLEY PLATE.
3. FILL VOID WITH INSULATION.
4. INSTALL VALLEY TRIM.
5. INSTALL SEALANTS.
6. FIELD CUT PANEL AND REMOVE CUT BACK.
7. FASTEN VALLEY ASSEMBLY.

- NOTES:**
- A. DETAILS ARE FOR GUIDELINES ONLY, AND MAY NOT BE SUITABLE FOR ALL BUILDING DESIGNS AND CONDITIONS.
  - B. SCREW LENGTHS MAY VARY PER CUSTOMER REQUEST. #12-14x1", #12-14x1 1/2", #12-14x2", #12-14x3" ARE AVAILABLE.

PROFILE	APPLICATION		
<b>IMP ROOF PANELS</b>	<b>COMMERCIAL - INDUSTRIAL</b>		
DETAIL	SHT.	DATE	REV.
<b>TRANSITION CONT. WALL TO ROOF RAKE</b>	<b>IMP-111</b>	<b>JAN 6/21</b>	<b>A</b>

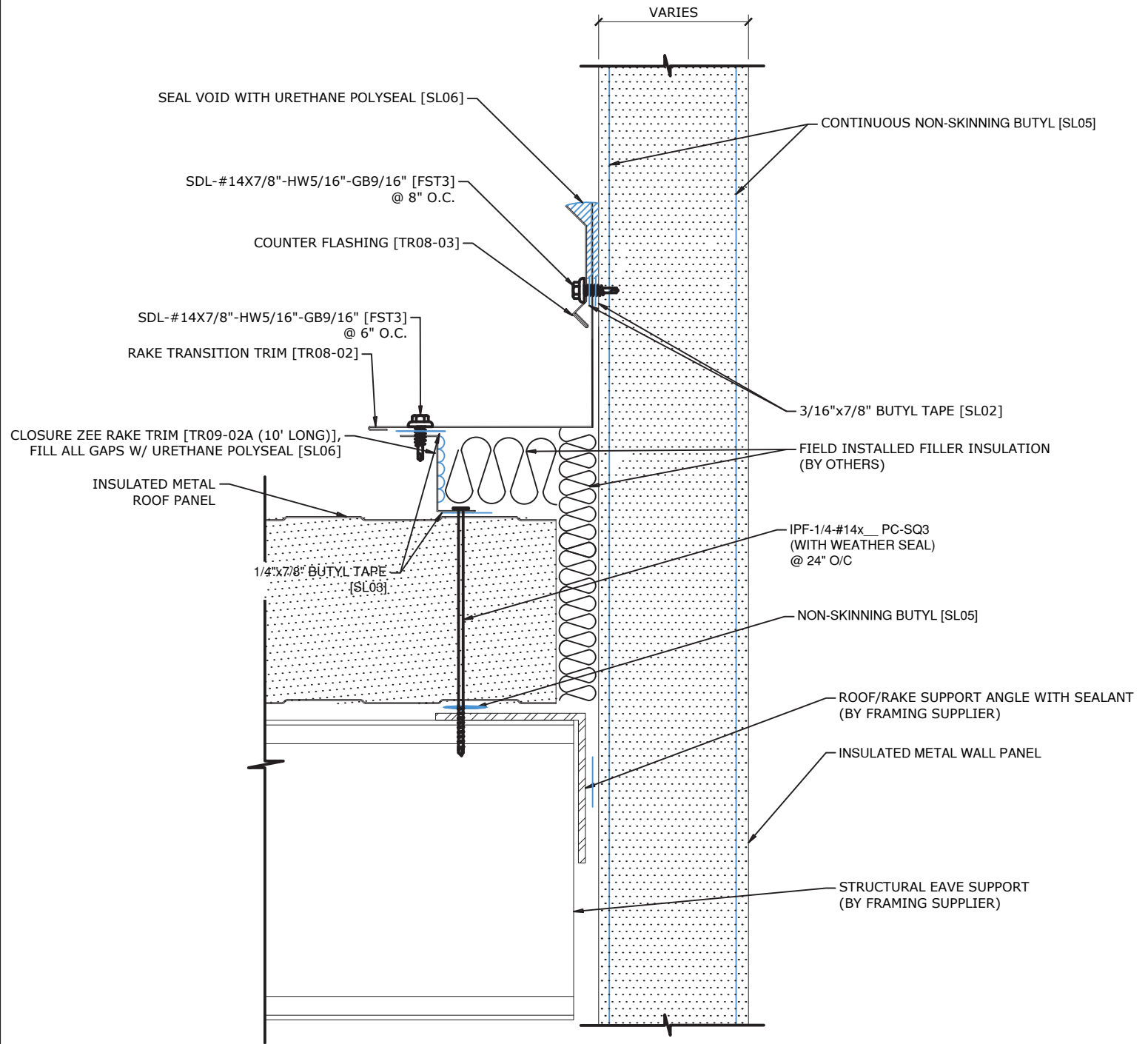

NOTES:  
 A. DETAILS ARE FOR GUIDELINES ONLY, AND MAY NOT BE SUITABLE FOR ALL BUILDING DESIGNS AND CONDITIONS.  
 B. SCREW LENGTHS MAY VARY PER CUSTOMER REQUEST. #12-14x1", #12-14x1 1/2", #12-14x2", #12-14x3" ARE AVAILABLE.

PROFILE	APPLICATION		
<b>IMP ROOF PANELS</b>	<b>COMMERCIAL - INDUSTRIAL</b>		
DETAIL	SHT.	DATE	REV.
<b>TRANSITION CONT. WALL TO HIGH EAVE</b>	<b>IMP-111A</b>	<b>JAN 6/21</b>	<b>A</b>

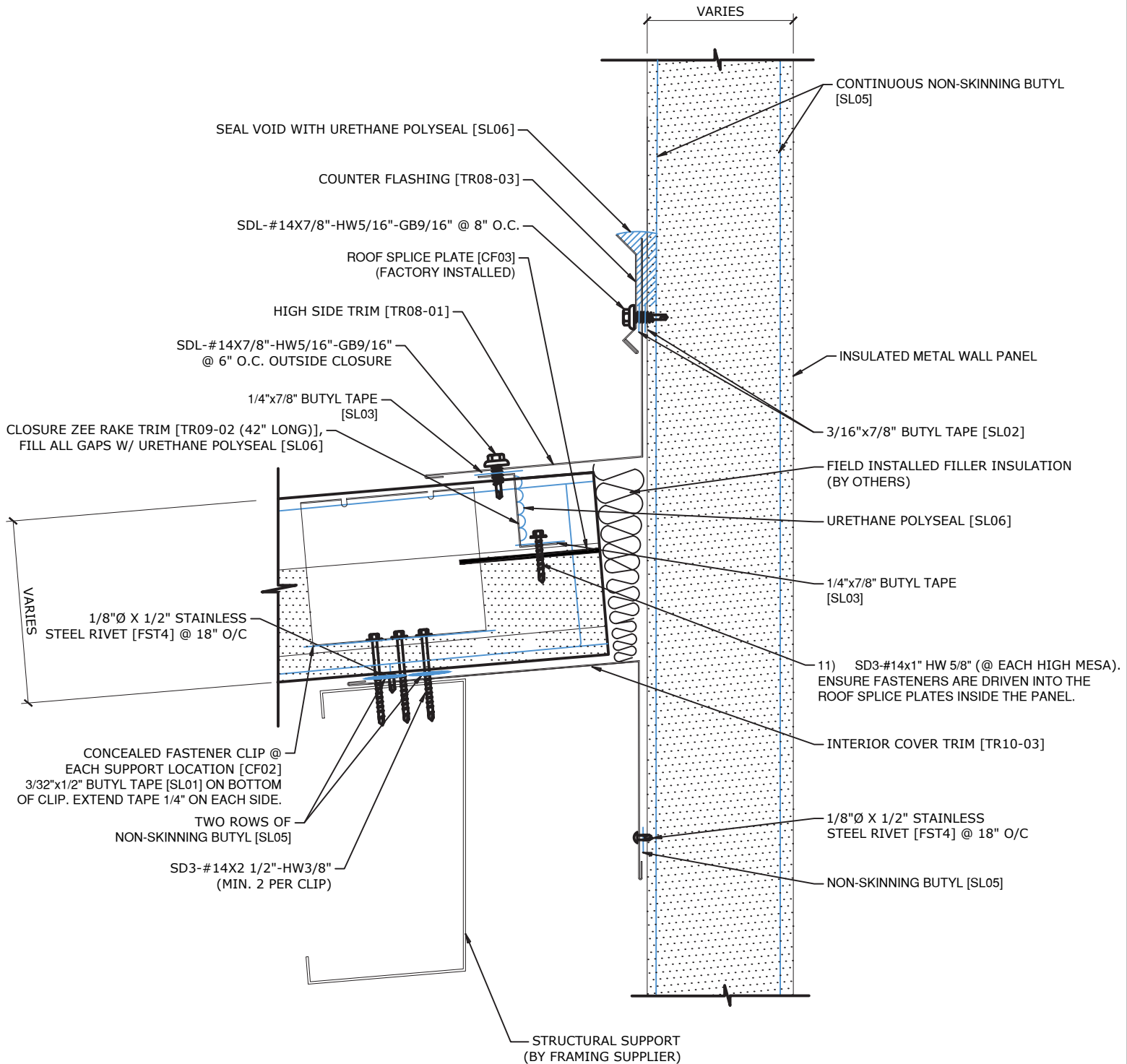

NOTES:  
 A. DETAILS ARE FOR GUIDELINES ONLY, AND MAY NOT BE SUITABLE FOR ALL BUILDING DESIGNS AND CONDITIONS.  
 B. SCREW LENGTHS MAY VARY PER CUSTOMER REQUEST. #12-14x1", #12-14x1 1/2", #12-14x2", #12-14x3" ARE AVAILABLE.

PROFILE	APPLICATION		
<b>IMP ROOF PANELS</b>	<b>COMMERCIAL - INDUSTRIAL</b>		
DETAIL	SHT.	DATE	REV.
<b>TRANSITION MASONRY WALL TO HIGH EAVE</b>	<b>IMP-112</b>	<b>JAN 6/21</b>	<b>A</b>

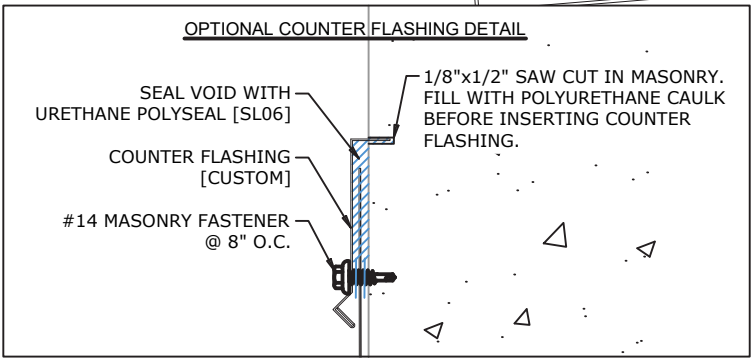
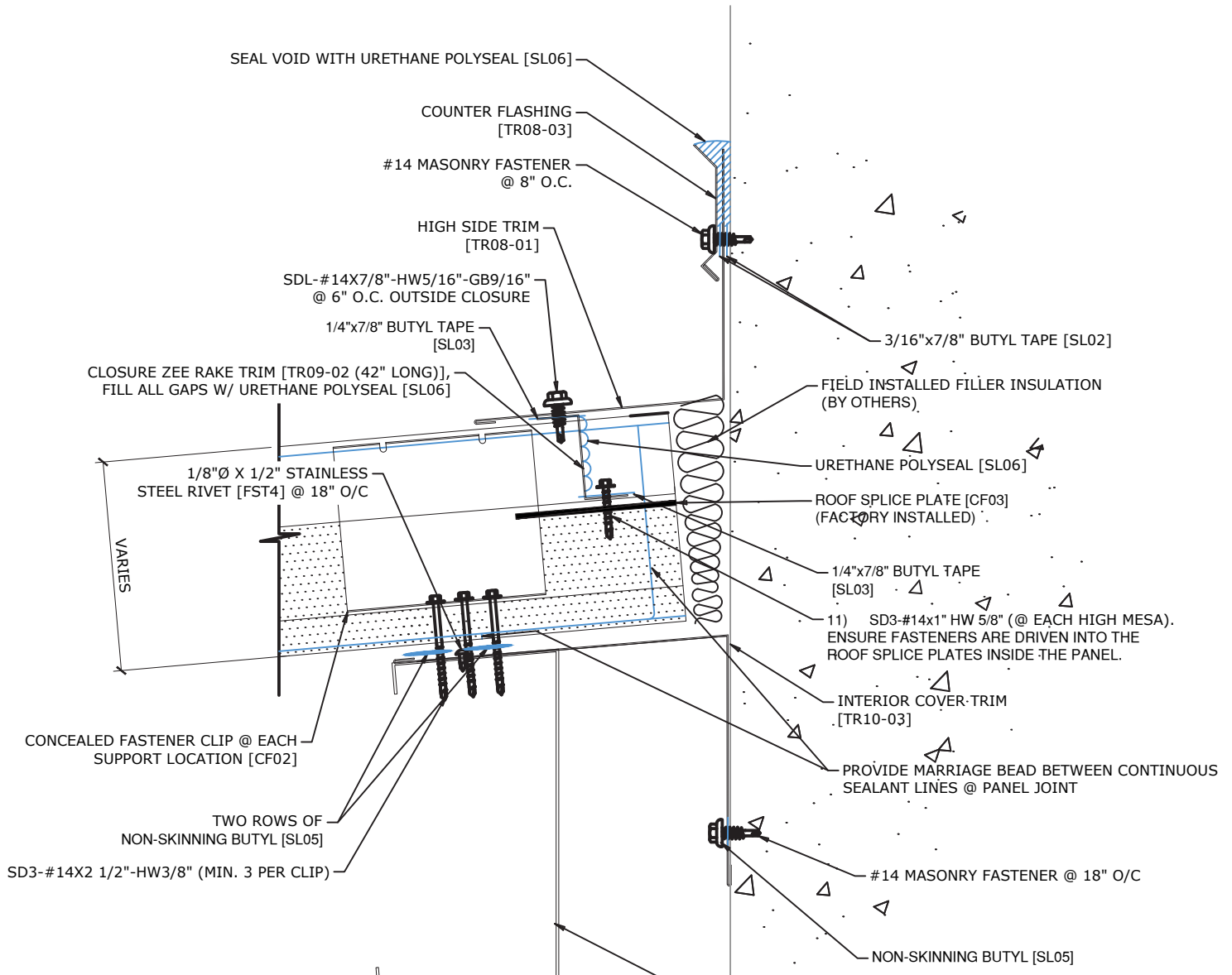

NOTES:  
 A. DETAILS ARE FOR GUIDELINES ONLY, AND MAY NOT BE SUITABLE FOR ALL BUILDING DESIGNS AND CONDITIONS.  
 B. SCREW LENGTHS MAY VARY PER CUSTOMER REQUEST. #12-14x1", #12-14x1 1/2", #12-14x2", #12-14x3" ARE AVAILABLE.

PROFILE	APPLICATION		
IMP ROOF PANELS	COMMERCIAL - INDUSTRIAL		
DETAIL	SHT.	DATE	REV.
TRANSITION MASONRY WALL TO RAKE	IMP-112A	JAN 6/21	A

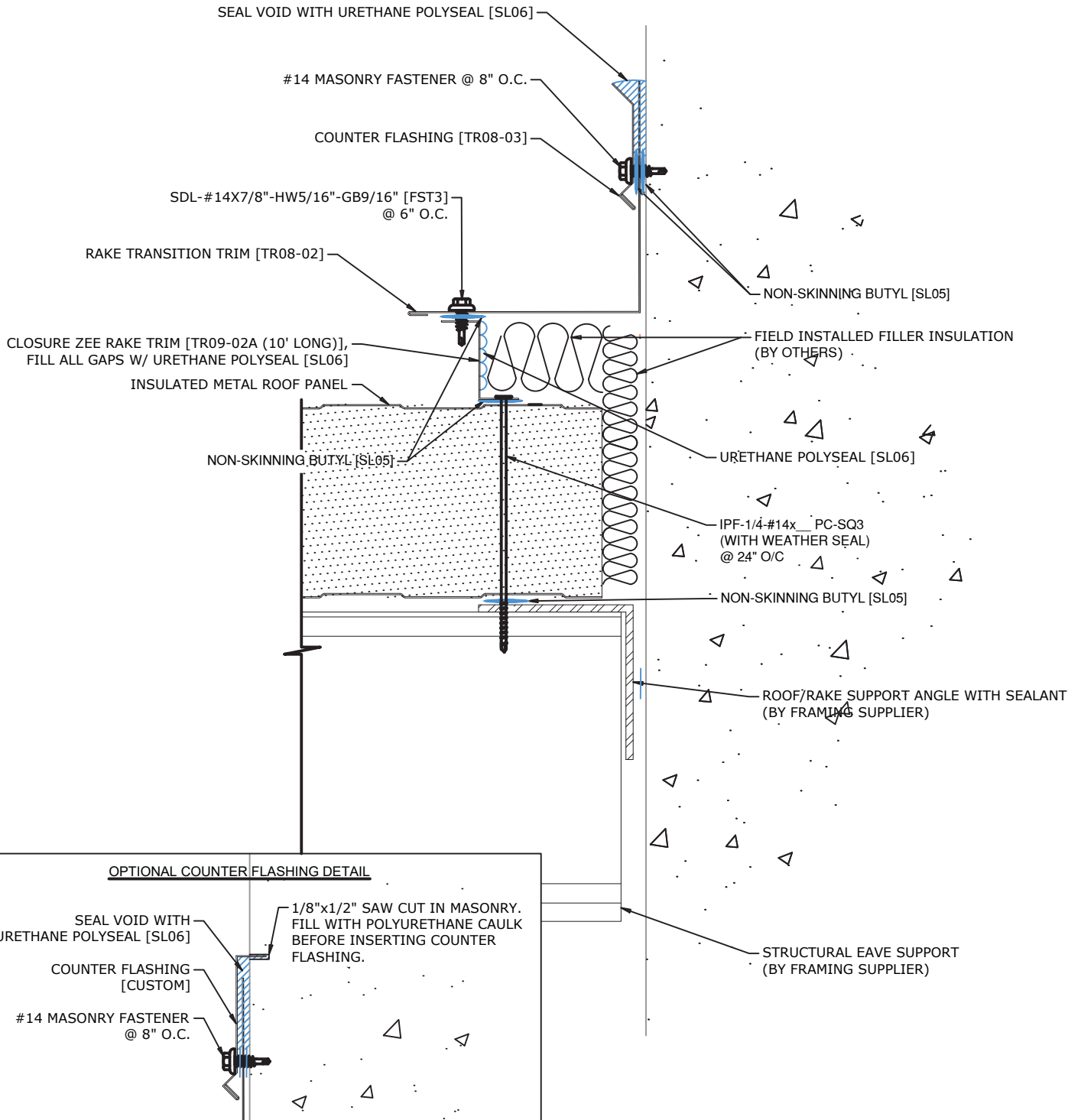

- NOTES:
- A. DETAILS ARE FOR GUIDELINES ONLY, AND MAY NOT BE SUITABLE FOR ALL BUILDING DESIGNS AND CONDITIONS.
  - B. SCREW LENGTHS MAY VARY PER CUSTOMER REQUEST. #12-14x1", #12-14x1 1/2", #12-14x2", #12-14x3" ARE AVAILABLE.